

Conversion of first floor office accommodation to 2 flats to be known as:

**Flat 1 & Flat 2**

3 Pump Lane, THAME OX9 3BT

Also, removal of commercial addresses:

**Hickman Shearer Ltd. and Pluris**

at 3 Pump Lane, THAME OX9 3BT

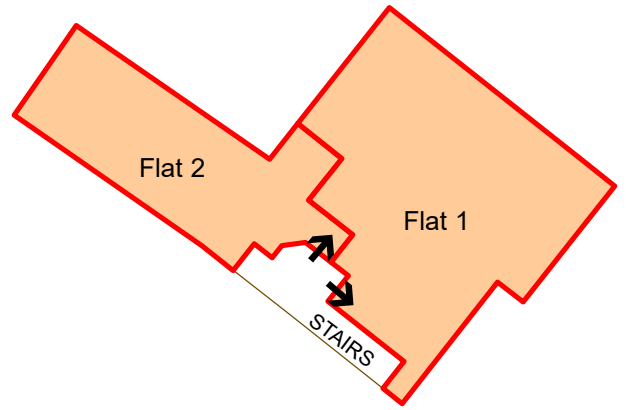

First floor, 3 Pump Lane

